



특징 (Character)

- 캠 롤러 방식의 초소형 각도개폐방식
Angular type by cam & roller driving unit
- 본제품은 몸체의 원통부를 잡는 방식으로 취부합니다.
This type is to grip the body's cylinder part.
- 소형전자부품의 파지에 적합한 NORMAL OPEN의 빠른 응답성
Suitable for gripping small electric parts.
- 마그네틱 센서 사용이 불가능
Magnetic sensor is not available



캠 롤러 방식 (Cam roller type)

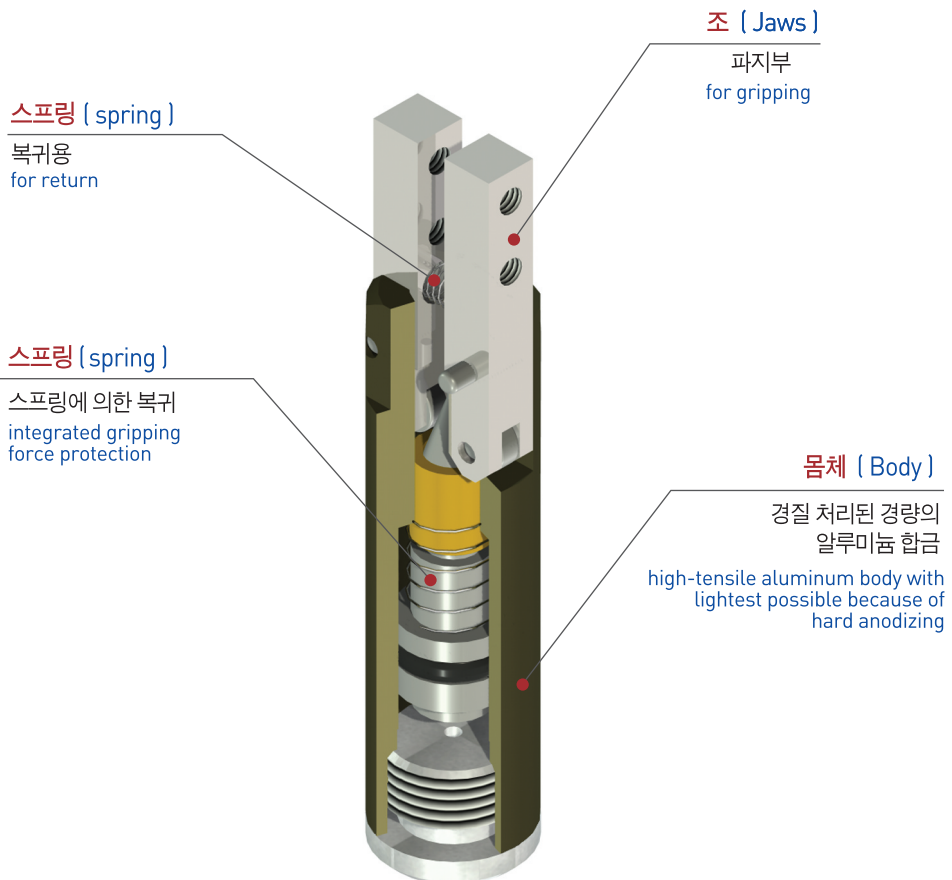

부품분해도 (Exploded view)

※ 본 분해도에는 한 제품을 예시하였으므로 기종별로 차이가 있을 수 있습니다
 ※ This is exploded view illustrates a certain product only. The contents may vary by product models.

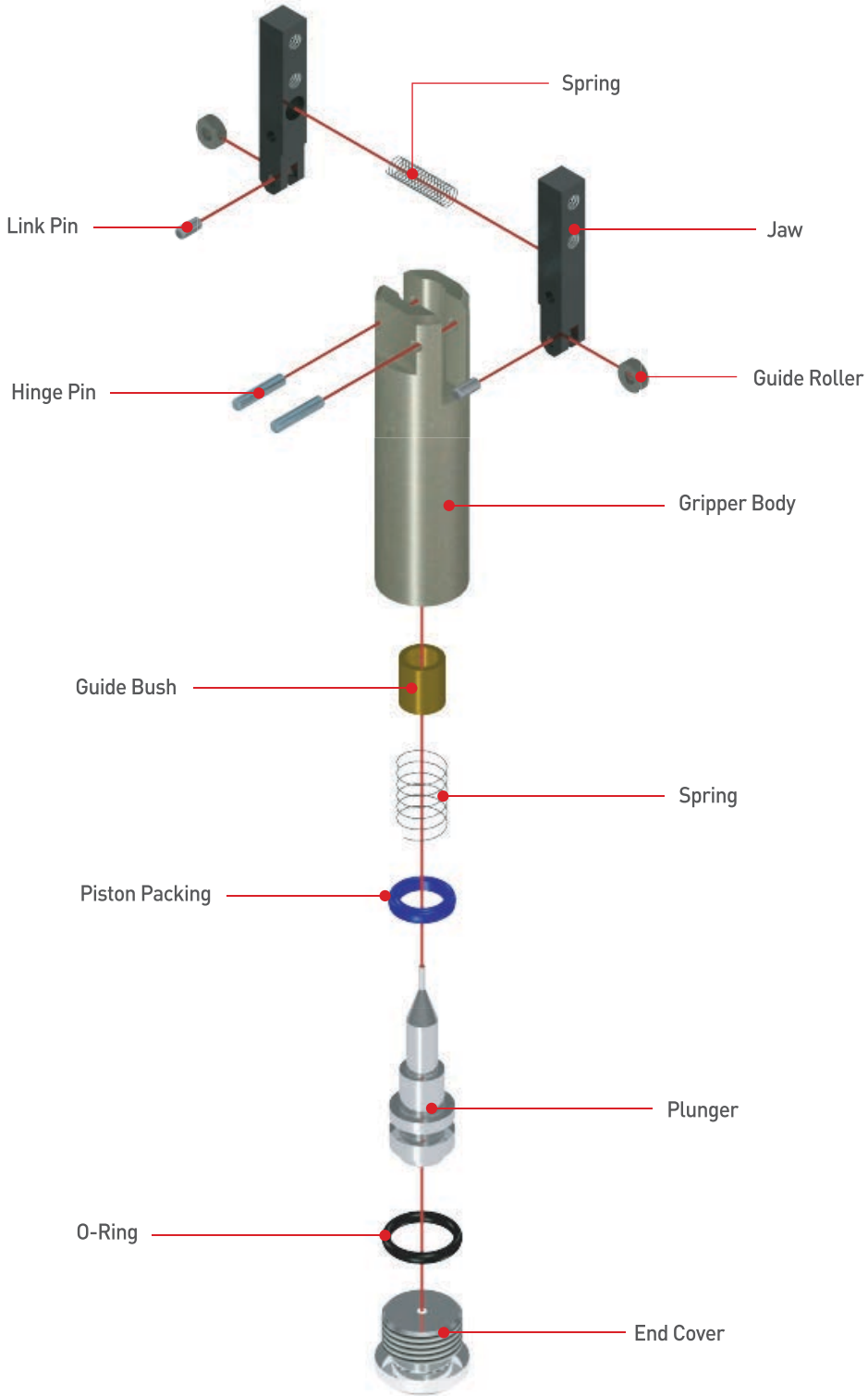

- AF101
- AF02
- AF03
- AF04P
- AF105P
- AF06
- AF10
- AF13
- AF13C
- AF14
- AF15
- AF316
- AF17
- AF117
- AF19**
- AF24
- AF26
- AF28D
- AF30
- AF30L
- AF30SP
- AF40
- AF46
- AF56N
- RAF56N
- MF16

주문기호 (Ordering Code)

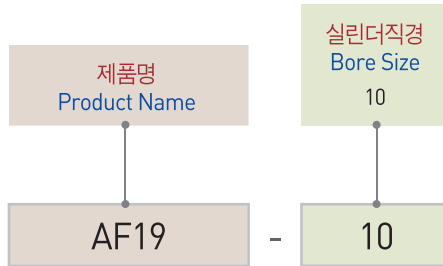

제품사양 (Specification)

P=공기압력(bar) , L=작용점까지의 거리(mm)
P=Air Pressure(bar) , L=Exertion length(mm)

제품명칭 Products Name	AF19-10	단위 Unit
개폐범위 Working angle	-7 to 14	degree
제품중량 Weight	0.04	kg
최대치구길이 Max. length of attach	30	mm
배관접속구 Fitting size	M5	
파지력 : 열림시 Gripping force : Open	-	N
파지력 : 닫힘시 Gripping force : Close	5.9(P-1.5)/0.1L	
연속사용회수 Continuation usage amount	60	cpm
사용압력 Operation pressure	3 to 7	bar
주위온도 Ambient temperature	-5 to 60	℃
윤활 Lubrication	불필요 Needless	

반복정밀도 : 연속 100회 작동후 측정치
After 100 consecutive strokes to end positions

작용점에서의 파지력 (Gripping Force From a Point of Action)

범례 (Legend) : —■ 7[bar] —■ 5[bar] —■ 3[bar]

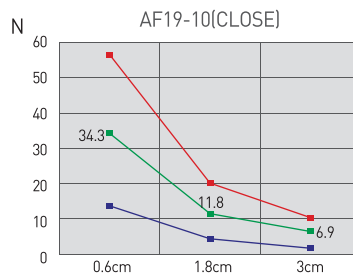

AF19-10

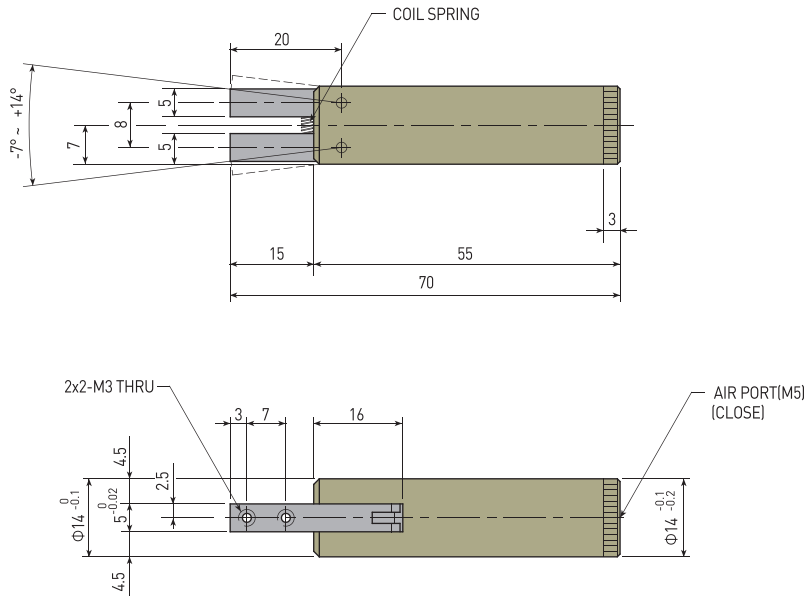

NOTE

- AF101
- AF02
- AF03
- AF04P
- AF105P
- AF06
- AF10
- AF13
- AF13C
- AF14
- AF15
- AF316
- AF17
- AF117
- AF19**
- AF24
- AF26
- AF28D
- AF30
- AF30L
- AF30SP
- AF40
- AF46
- AF56N
- RAF56N
- MF16